

## G1.13B Y-STRAINER



### APPLICATION

General uses: Waste water filtering systems.

### GENERAL CHARACTERISTICS

From DN 15 to 600,  
Cast iron "Y" body, cast iron bonnet.  
Dismountable stainless steel screen.  
Flanged ends PN 16/PN10.

### WORKING CONDITIONS

Maximum working pressure : 16 bar.  
Maximum temperature : -10°C ~ + 120°C.

### STANDARDS

Pressure test according to standards EN 12266-1, DIN 3230, BS 5154 and ISO 5208 :Body:24 bar.  
Face to face according to standards EN 558-1serie 1 and DIN 3202/1 serie F1.  
Flanges drilled according to EN 1092-2 PN16/PN10.

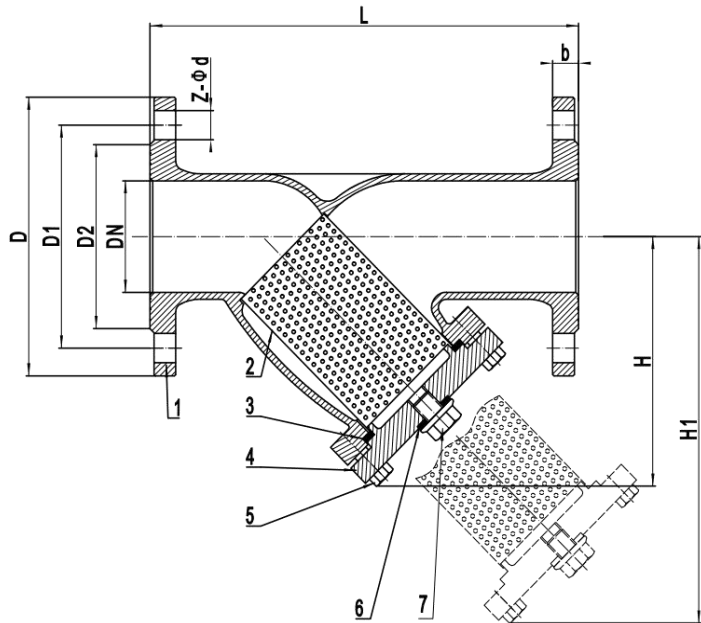
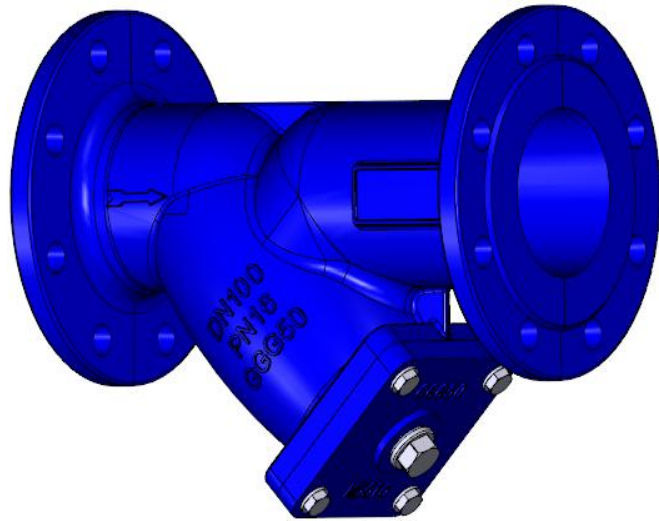

NO.	PART NAME	MATERIAL
1/4	BODY/ BONNET	DUCTILE IRON/GGG50/ EN-GJS500-7
2	SCREEN	STAINLESS STEEL/SS304/SS316
3/6	GASKET	EPDM(WRAS/ ACS) /NBR
5	SCREW	STAINLESS STEEL A2-70 /A4-70
7	PLUG	STAINLESS STEEL/SS304/SS316

Structure														
DN	L	D		D1		D2		b	Z-φb		H	H1	KG	MESH
		PN10	PN16	PN10	PN16	PN10	PN16		PN10	PN16				
15	130	95		65		45		14	4-14		65	116	3	1mm
20	150	105		75		58		16	4-14		75	131	3.5	
25	160	115		85		68		16	4-14		82	145	4	
32	180	140		100		78		18	4-18		104	174	5	
40	200	150		110		88		18	4-18		106	180	6	
50	230	165		125		102		19	4-18		120	225	7.5	
65	290	185		145		122		19	4-18		145	272	10	1.3mm
80	310	200		160		138		19	8-18		170	310	11	
100	350	220		180		158		19	8-18		185	365	16.5	
125	400	250		210		188		19	8-18		255	470	28	1.6mm
150	480	285		240		212		19	8-23		300	547	33	
200	600	340		295		268		20	8-23	12-23	360	660	52	
250	730	395	405	350	355	319		22	12-23	12/28	455	795	100	
300	850	445	460	400	410	370		24	12-23	12/28	500	881	130	
350	980	520		460	470	429		26	16-23	16-28	615	1155	210	
400	1100	580		515	525	480		28	16-28	16-30	690	1326	270	
450	1200	640		565	585	530	548	30	20-28	20-30	730	1385	350	
500	1250	715		620	650	582	609	31	20-28	20-34	800	1455	420	
600	1450	840		725	770	682	720	36	20-31	20-37	930	1655	600	

DN15-DN100



DN125-DN700

