

**PRODUCTION STANDARDS:**

DESIGN:EN12334/EN16767  
 CONNECTION:FLANGED EN 1092-2  
 FACE TO FACE :BS5153/F3202 F6  
 TESTS:EN12266-1

**WORKING CONDITIONS**

Maximum working pressure : 16 bar.  
 Maximum temperature : -10°C ~ +80°C.

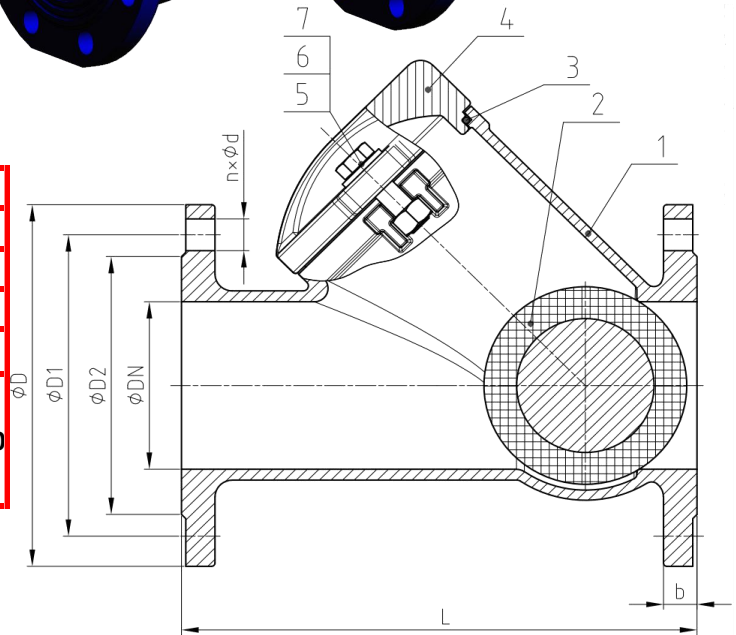

ITEM	PART NAME	MATERIAL
1	BODY	DUCTILE IRON/GGG50
2	BALL	STEEL+EPDM
3	BONNET GASKET	EPDM / NBR
4	BONNET	DUCTILE IRON/GGG50
5/6/7	BOLTING/ GASKET/NUT	STAINLESS STEEL / A2-70

Structure											
DN	L		D		D1		D2		b	n-ød	
	BS5153	DIN-F6	PN10	PN16	PN10	PN16	PN10	PN16		PN10	PN16
50	203	200	165	165	125	125	102	102	19	4-ø19	4-ø19
65	216	240	185	185	145	145	122	122	19	4-ø19	4-ø19
80	241	260	200	200	160	160	138	138	19	8-ø19	8-ø19
100	292	300	220	220	180	180	158	158	19	8-ø19	8-ø19
125	330	350	250	250	210	210	188	188	19	8-ø19	8-ø19
150	356	400	285	285	240	240	212	212	19	8-ø23	8-ø23
200	495	500	340	340	295	295	268	268	20	8-ø23	12-ø23
250	622	600	395	405	350	355	320	320	22	12-ø23	12-ø27
300	698	700	445	460	400	410	370	378	24	12-ø23	12-ø27
350		800	505	520	460	470	429	429	26.5	16-ø23	16-ø28
400		900	565	580	515	525	480	480	28	16-ø28	16-ø31
500		1100	670	715	620	650	582	609	31.5	20-ø28	20-ø34
600		1300	780	840	725	770	682	720	36	20-ø31	20-ø37